

New flat roof

Foamseal

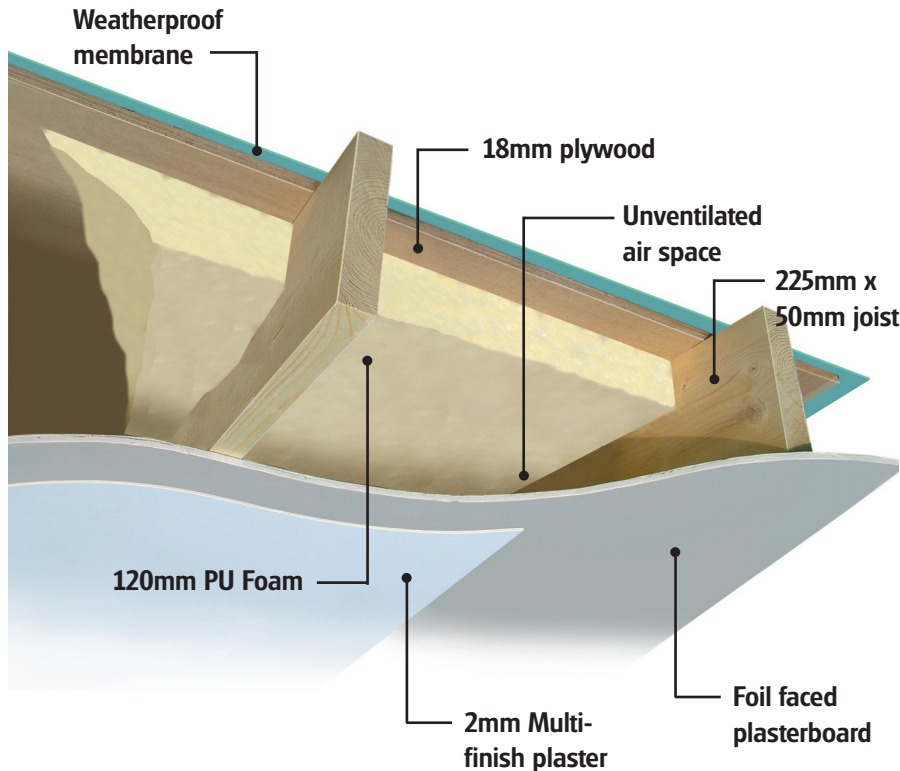

General

Specification: BBA Certificate 02/3964
Spray applied Foamseal polyurethane foam between joists, directly onto OSB ply.
Average depth: 120mm 150mm
U-value: 0.19W/m²K 0.16W/m²K
Condensation risk: Zero
Ventilation: Unventilated warm deck
Additional insulation: Foil-faced plasterboard at ceiling level

Foamseal is applied directly to the underside of the timber decking to create a warm deck composite roof structure without the need for a ventilation gap to remove condensation. It is essential that elements are designed and constructed to incorporate normal precautions against moisture ingress before the application of the product. When installed in a floor, wall or ceiling, the product will be contained by the floor finish or lining board until these layers are destroyed. Therefore the product will not contribute to the development stages of a fire or present a smoke or toxic hazard. When installed between the joists and lined with a minimum of 12.5mm thick Type 5 plasterboard, a period of fire resistance, from inside to out, in excess of 30 minutes will be achieved. Foamseal is hypoallergenic and contains no fibres, dust or noxious vapours. The sound attenuation properties of the structure are improved.

U-value and Condensation Risk Analyses

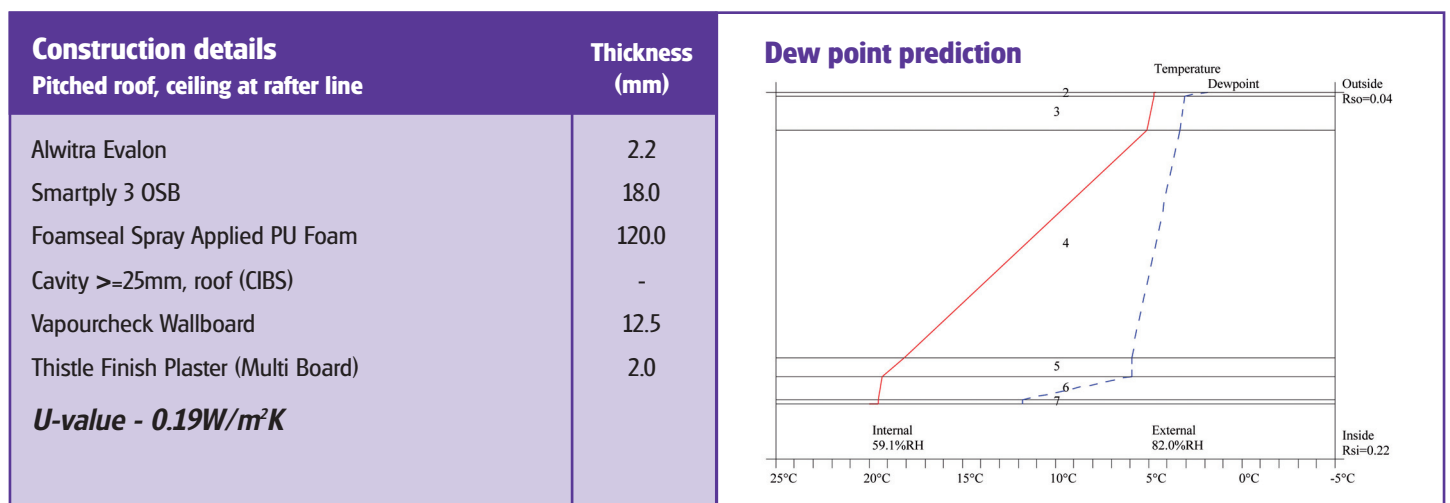

These calculations take into account repeating thermal bridges using methods in ISO 6946 (walls and roofs), ISO 13370 (ground floors) and analyses interstitial condensation risk using the method in BS EN ISO 13788:2002 (and BS 5250 Appendix D) to help you demonstrate compliance with the Building Regulations and Building Standards. Each project must be assessed individually and therefore examples here can only be illustrative.